

# Vesta™

## Quick Reference Guide

Model BLMVE



**FOR THE LOVE OF SEWING**

To register your machine warranty and receive Baby Lock product updates and offers, go to [babylock.com/login](http://babylock.com/login). If you have questions with registration, visit your Authorized Baby Lock Retailer.

Baby Lock Consumer Helpline: 800-313-4110

[www.BabyLock.com](http://www.BabyLock.com)

Brought to You by Tacony Corporation®.



**Before using your machine for the first time please read the “IMPORTANT SAFETY INSTRUCTIONS” in the Instruction and Reference Guide.**

Refer to the Instruction and Reference Guide for detailed instructions.

In this guide, English screens are used for basic explanations.

For details on the built-in embroidery patterns, refer to the Embroidery Design Guide.

**Antes de utilizar la máquina por primera vez, lea las “INSTRUCCIONES DE SEGURIDAD IMPORTANTES” en la Guía de referencia y de instrucciones.**

Consulte las instrucciones detalladas en la Guía de referencia y de instrucciones.

En esta guía, para las explicaciones básicas se emplean pantallas en inglés.

Para más información acerca de los patrones de bordado integrados, consulte la Guía de diseños de bordado.

**Avant d'utiliser votre machine pour la première fois, veuillez lire les « INSTRUCTIONS DE SÉCURITÉ IMPORTANTES » du guide d'instructions et de référence.**

Reportez-vous au guide d'instructions et de référence pour des instructions détaillées.

Dans ce guide, des écrans en anglais sont utilisés pour les explications de base.

Pour les détails sur les motifs de broderie intégrés, reportez-vous au guide de motifs de broderie.

## Contents

Bobbin Winding and Setting .....	2
Upper Threading .....	4
Selecting and Sewing Stitch Patterns .....	6
◆ Utility Stitches .....	6
◆ Decorative Stitches .....	7
◆ Character Stitches .....	7
Summary of Stitch Patterns.....	8
◆ Utility Stitches .....	8
◆ Decorative Stitches .....	9
◆ Character Stitches .....	10
Preparing to Embroider .....	16
Selecting Embroidery Patterns .....	18

## Contenido

Bobinado y ajuste .....	2
Hilo superior .....	4
Seleccionar y coser patrones .....	6
◆ Puntadas útiles .....	6
◆ Puntadas decorativas .....	7
◆ Puntadas de carácter .....	7
Resumen de tipos de puntada .....	8
◆ Puntadas útiles .....	8
◆ Puntadas decorativas .....	9
◆ Puntadas de carácter .....	10
Preparativos para bordar .....	16
Seleccionar patrones de bordado .....	18

## Table des matières

Bobinage et réglage de la canette .....	2
Enfilage supérieur .....	4
Sélection et couture de motifs .....	6
◆ Points utilitaires .....	6
◆ Points décoratifs .....	7
◆ Points de caractères .....	7
Sommaire des motifs de point.....	8
◆ Points utilitaires .....	8
◆ Points décoratifs .....	9
◆ Points de caractères .....	10
Préparation de la broderie .....	16
Sélection des motifs de broderie.....	18



# Bobbin Winding and Setting

## Bobinado y ajuste

### Bobinage et réglage de la canette

Follow the steps below in numerical order. Refer to the Instruction and Reference Guide for detailed instructions.

Siga los pasos descritos a continuación, en orden numérico. Consulte las instrucciones detalladas en la guía de referencia y de instrucciones.

Respectez les étapes ci-dessous, dans l'ordre numérique. Reportez-vous au guide d'instructions et de référence pour des informations détaillées.

Use only the included bobbin or bobbins of the same type.

Utilice solo la bobina incluida, o bobinas del mismo tipo.

N'utilisez que la canette fournie ou des canettes du même type.

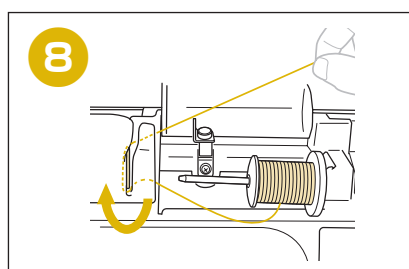
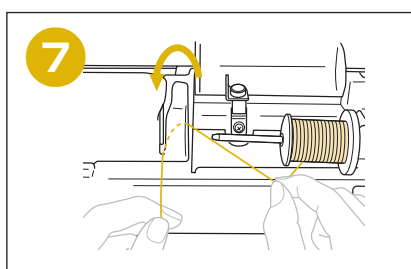
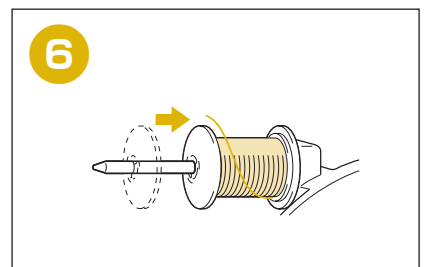
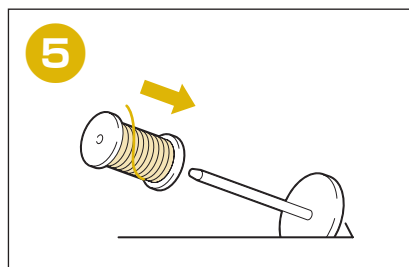
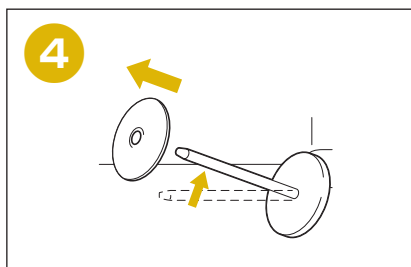
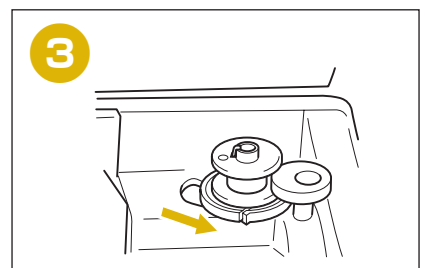
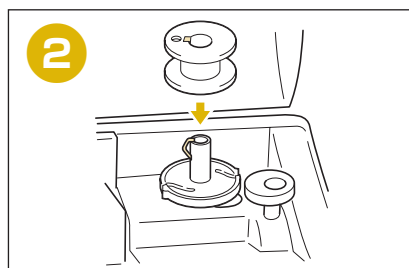
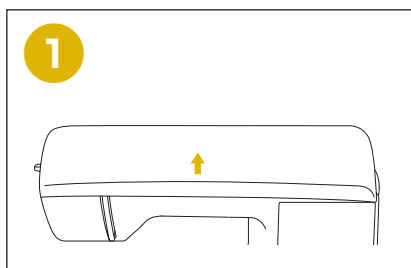
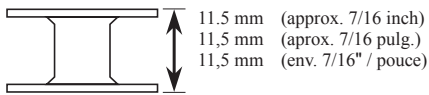
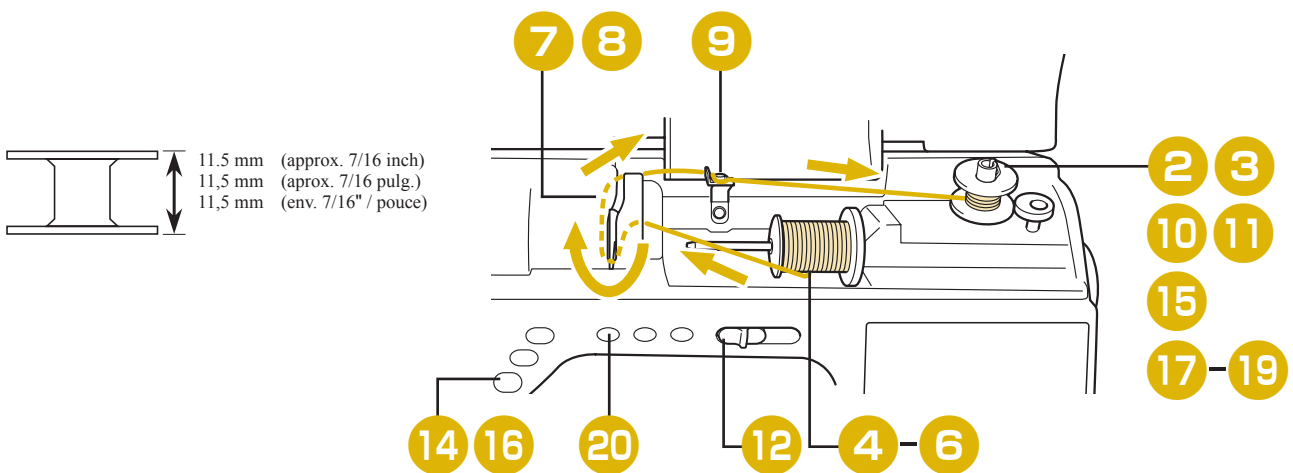

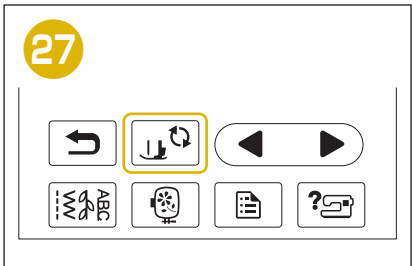
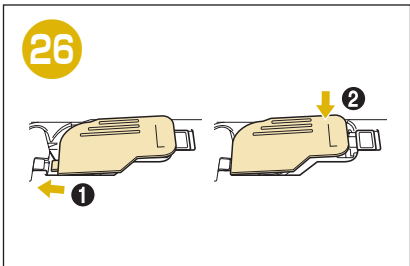
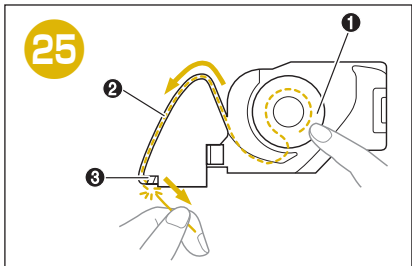
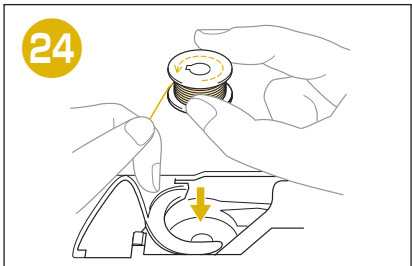
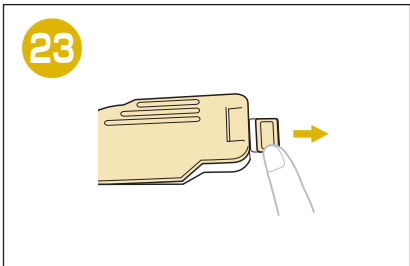
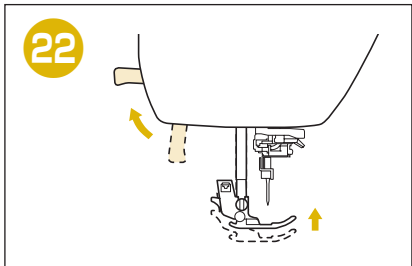
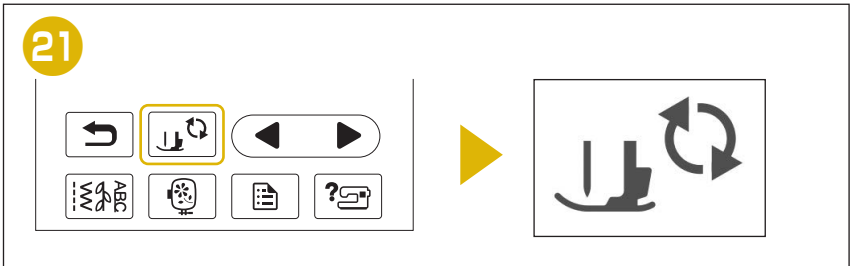
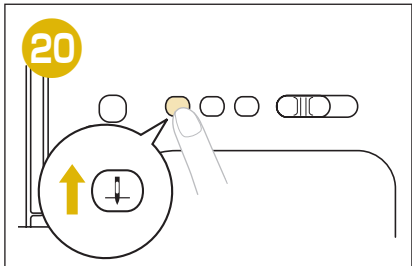
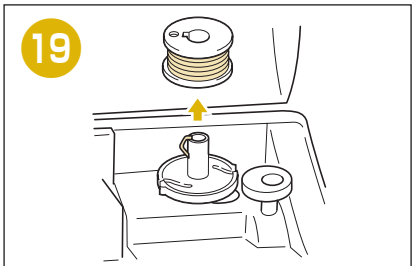
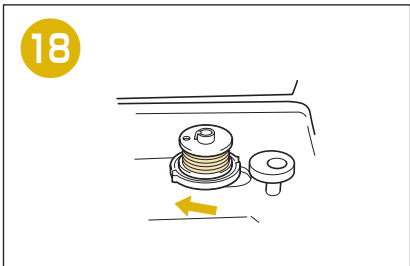
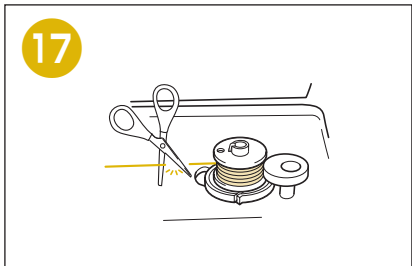
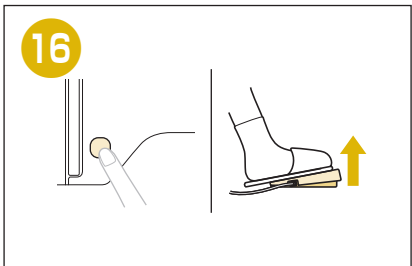
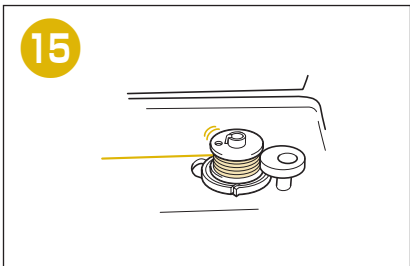
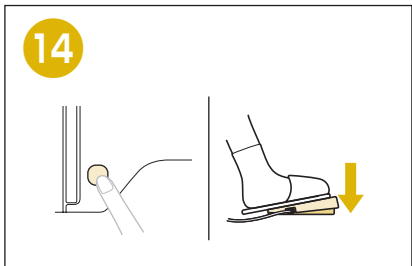
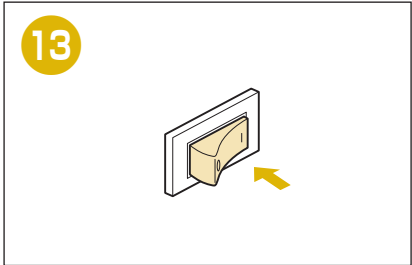
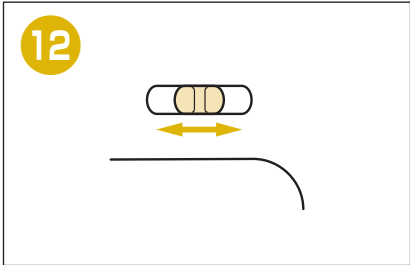
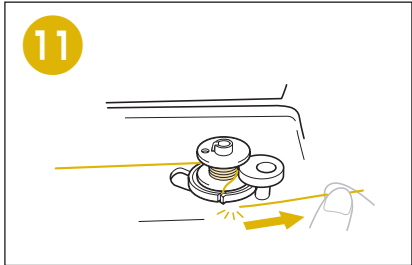
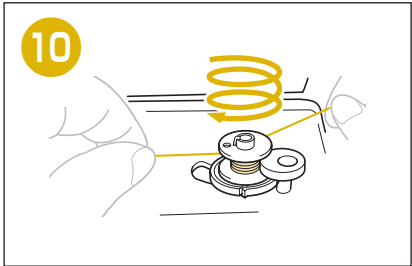
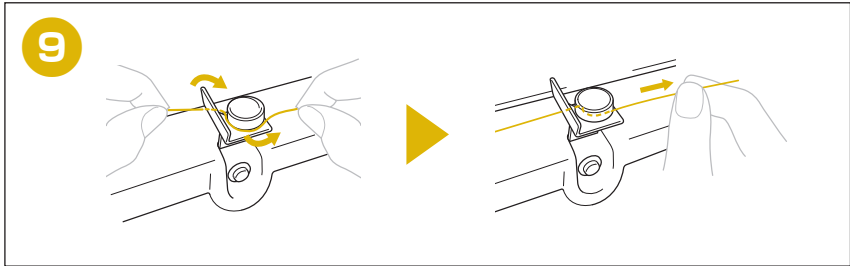



# Upper Threading

Hilo superior  
Enfilage supérieur

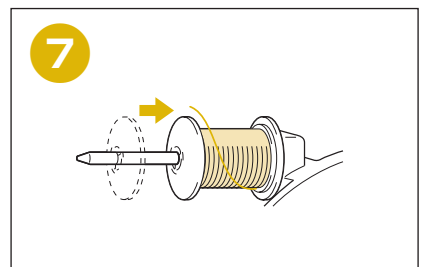
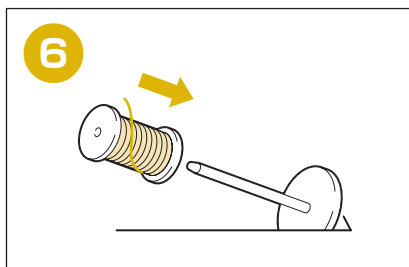
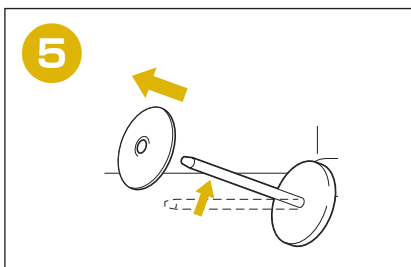
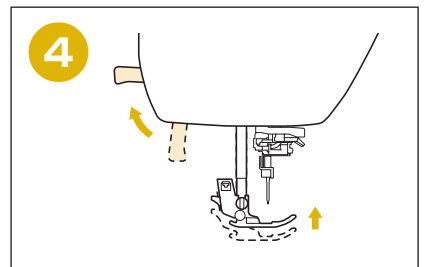
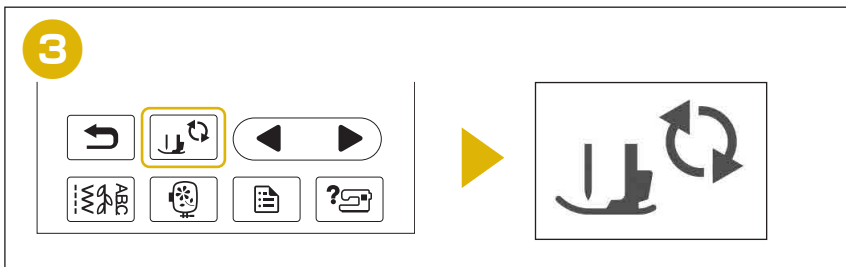
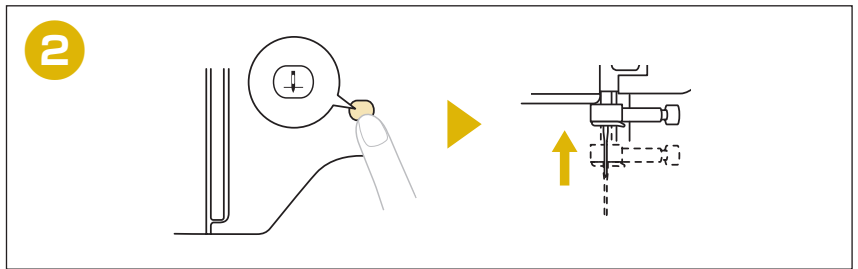
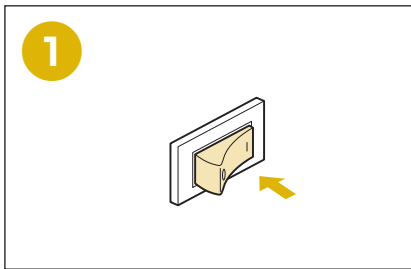
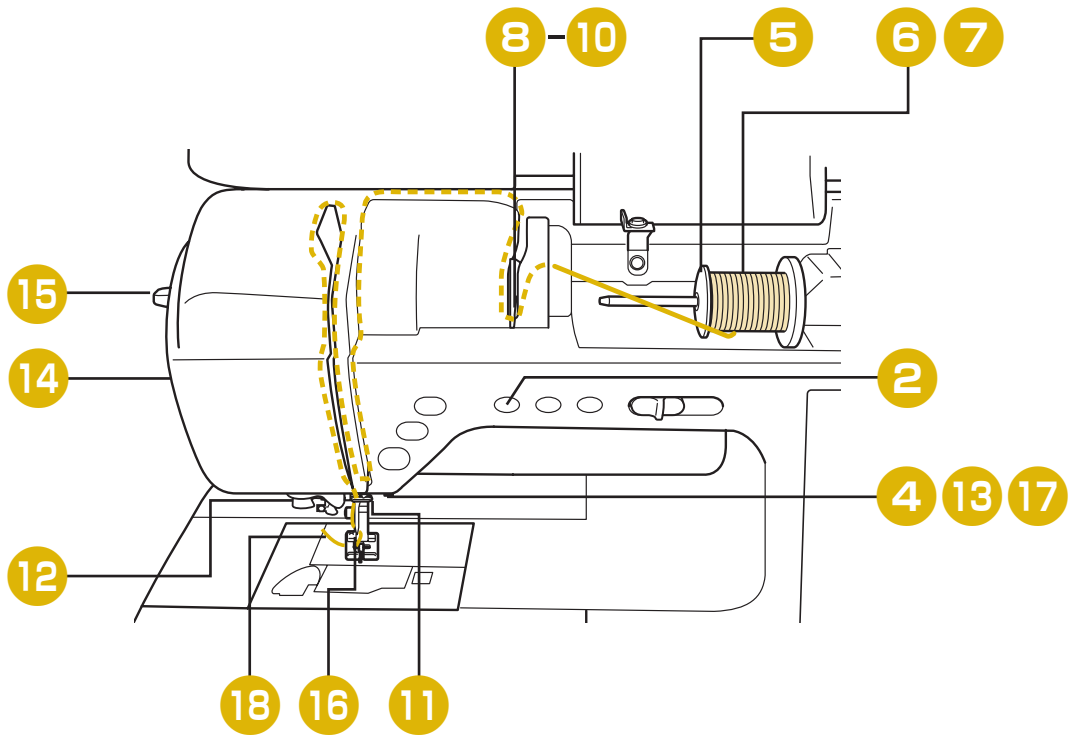

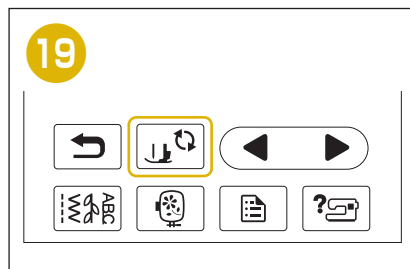
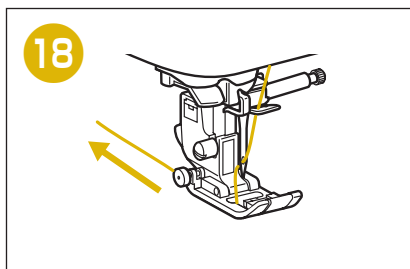
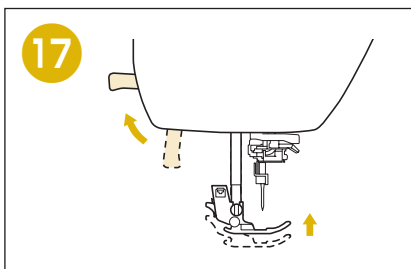
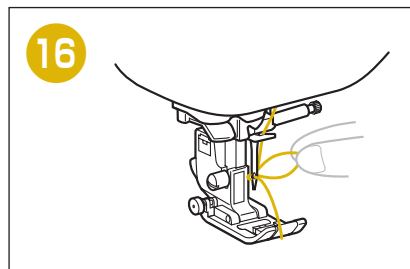
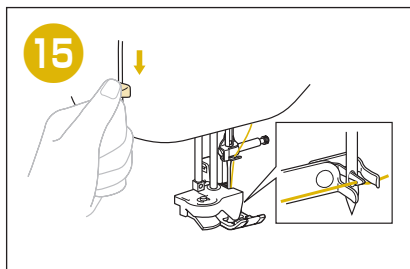
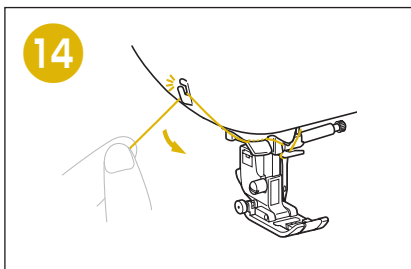
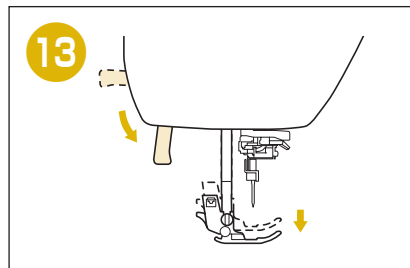
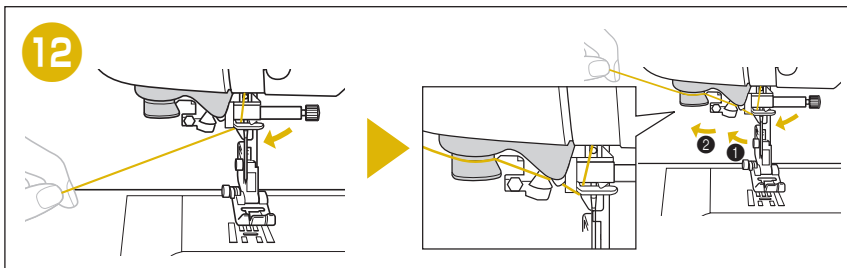
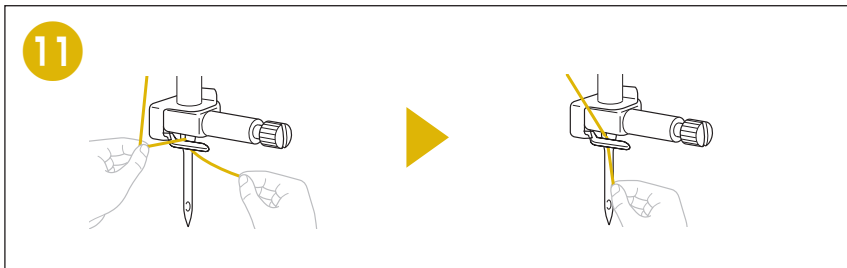
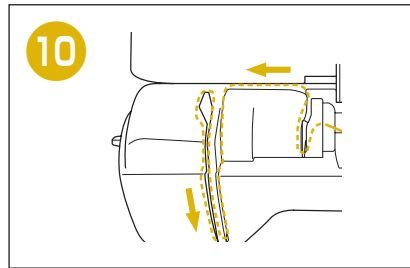
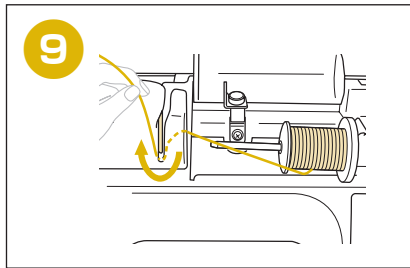
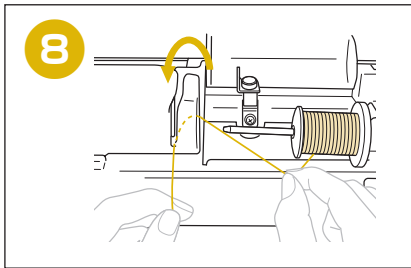

# Selecting and Sewing Stitch Patterns

## Seleccionar y coser patrones

## Sélection et couture de motifs

◆ Utility Stitches

◆ Puntadas utiles

◆ Points utilitaires

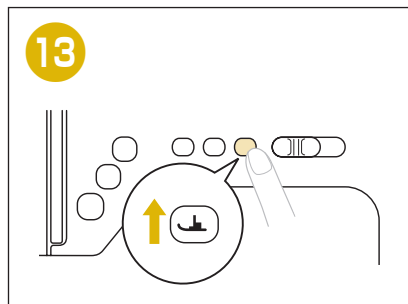
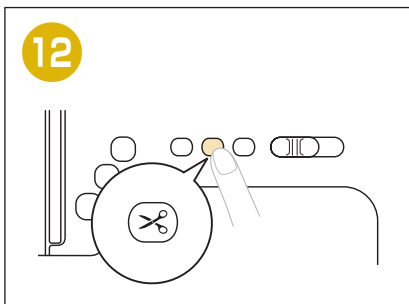
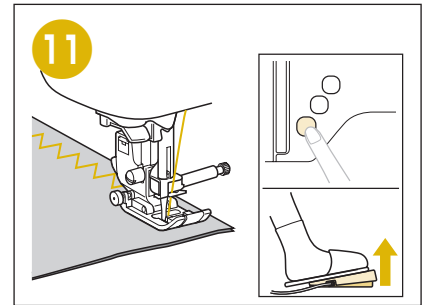
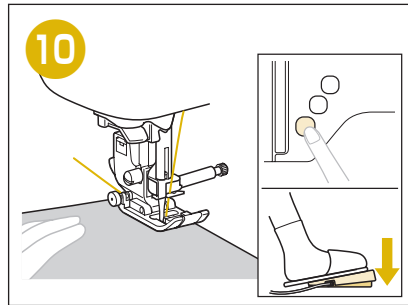
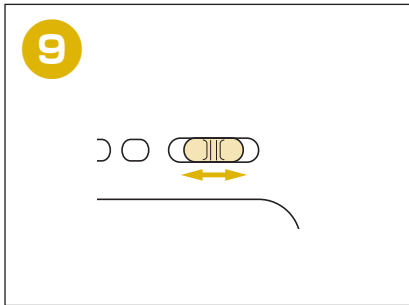
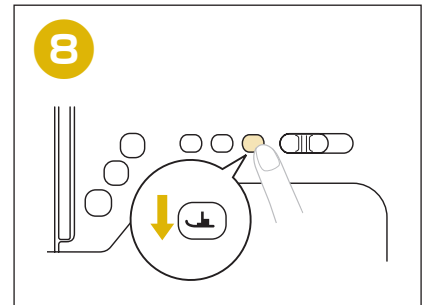
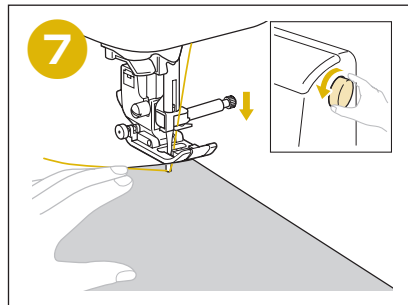
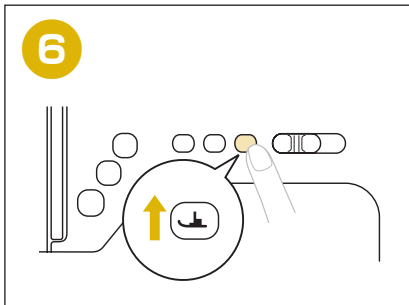
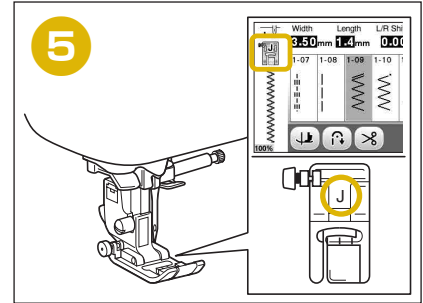
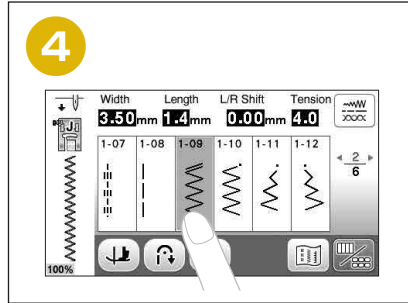
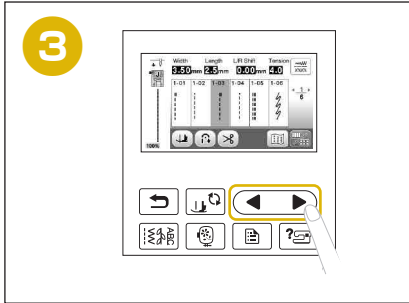
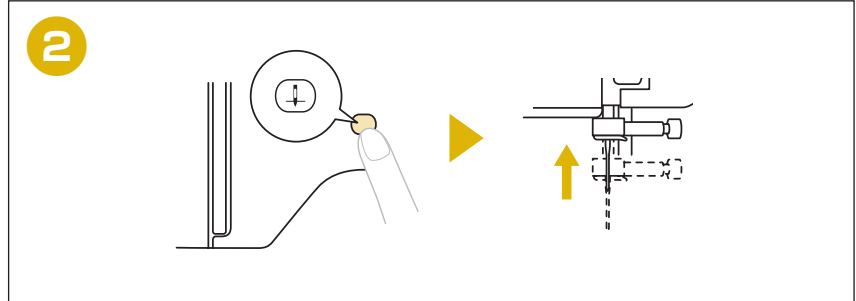
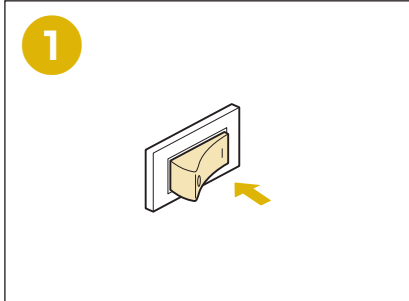



◆ Decorative Stitches ◆ Puntadas decorativas ◆ Points décoratifs

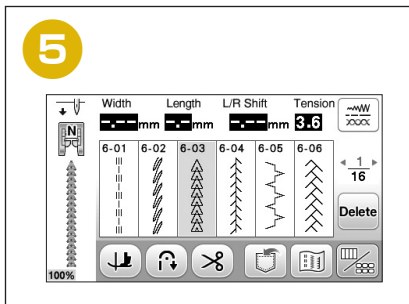
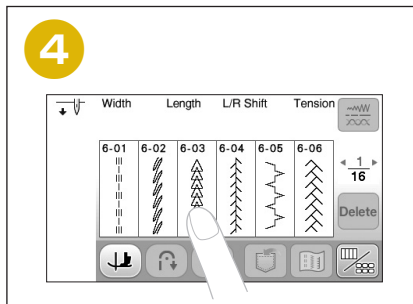
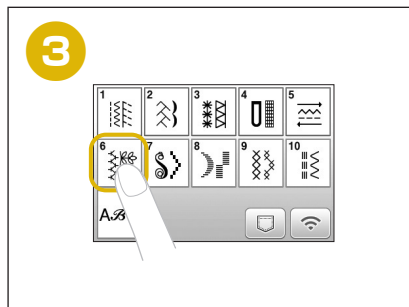
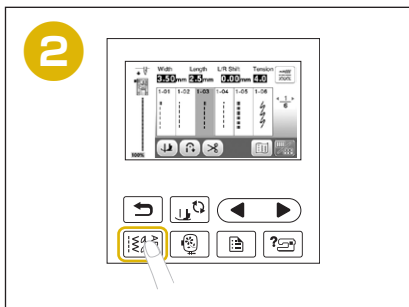
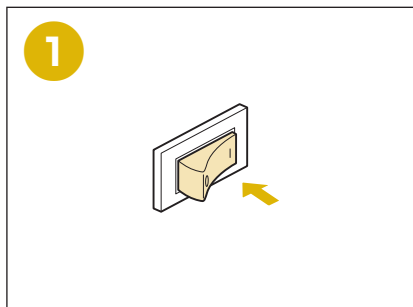

◆ Character Stitches ◆ Puntadas de carácter ◆ Points de caractères

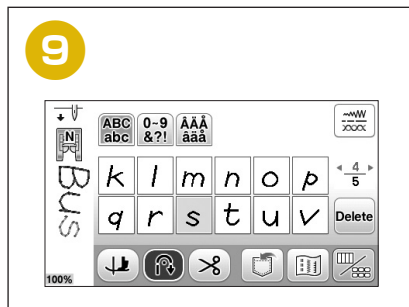
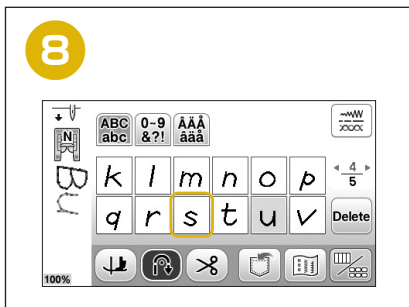
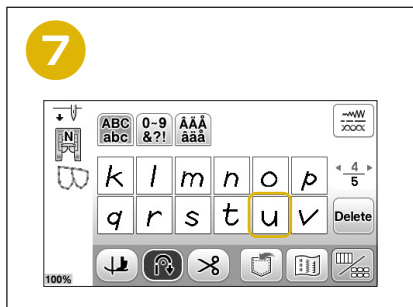
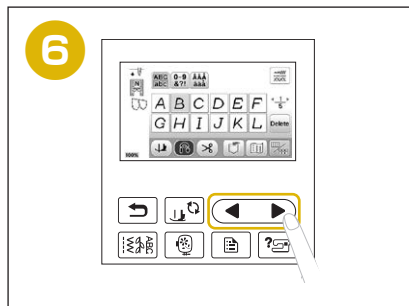
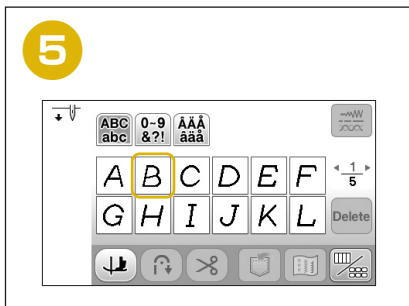
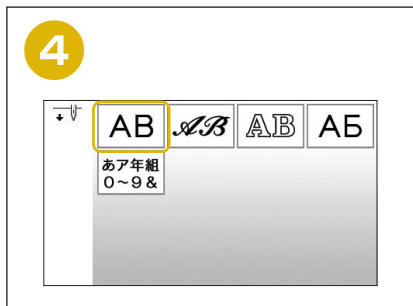
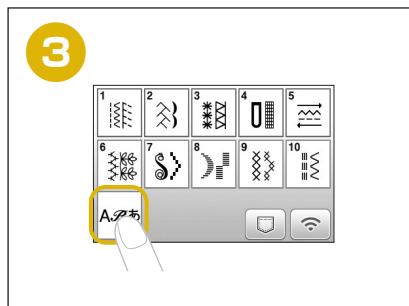
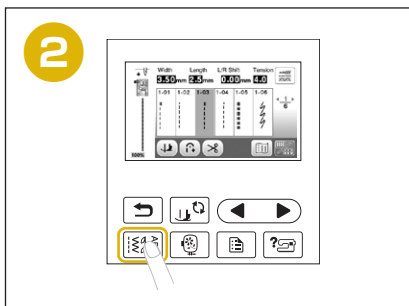
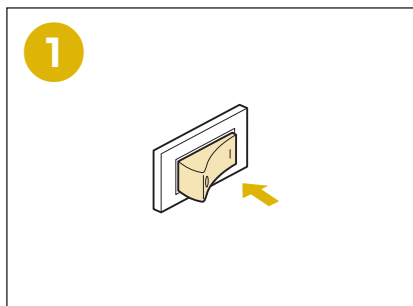



# Summary of Stitch Patterns

## Resumen de tipos de puntada

## Sommaire des motifs de point

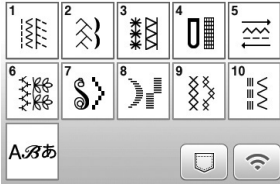

### ◆ Utility Stitches

### ◆ Puntadas utiles

### ◆ Points utilitaires

#### • 1-01~1-35

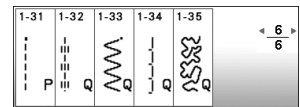
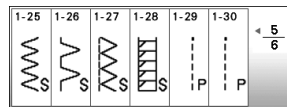
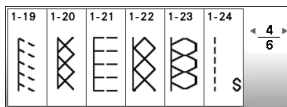
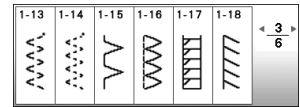
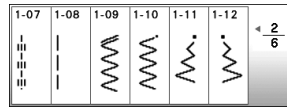
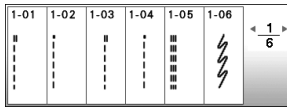

#### • 2-01~2-20

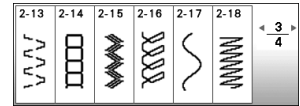
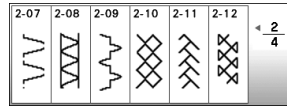
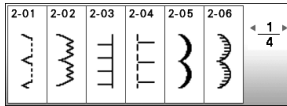

#### • 3-01~3-22

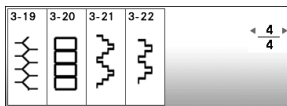
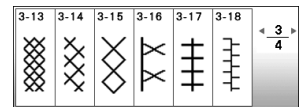
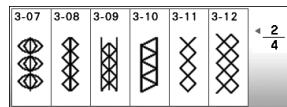
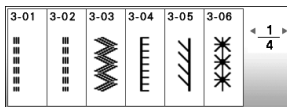

#### • 4-01~4-15

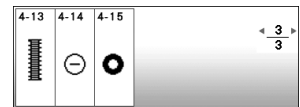
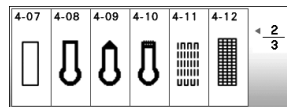
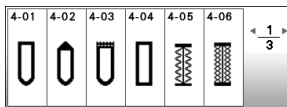

#### • 5-01~5-08

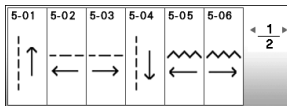

◆ Decorative Stitches ◆ Puntadas decorativas ◆ Points décoratifs

• 6-01~6-94

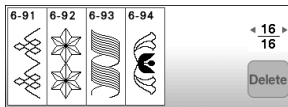
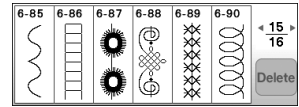
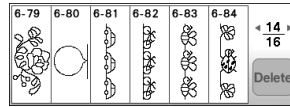
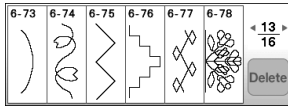
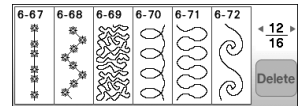
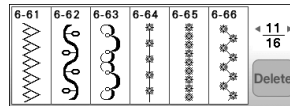
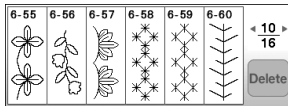
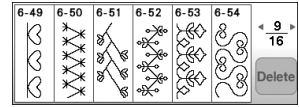
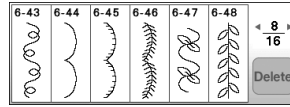
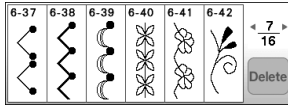
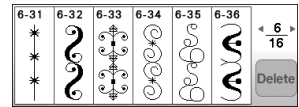
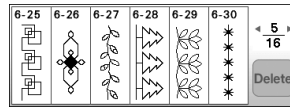
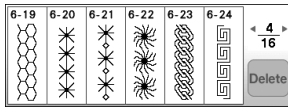
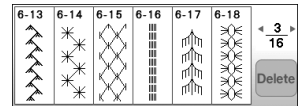
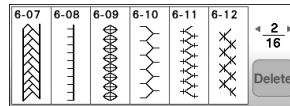
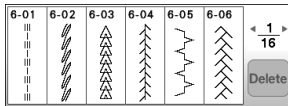

• 7-01~7-18

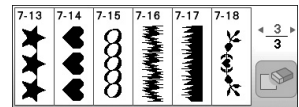
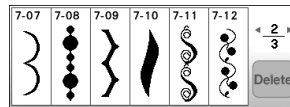
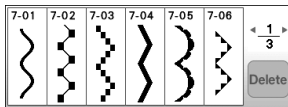

• 8-01~8-17

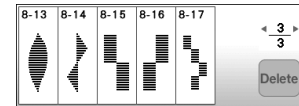
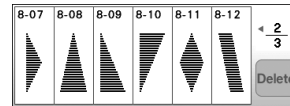
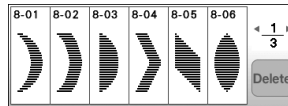

• 9-01~9-14

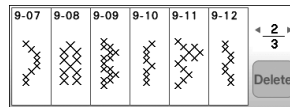
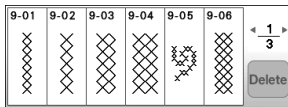

• 10-01~10-58

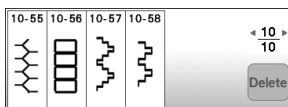
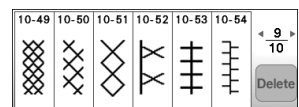
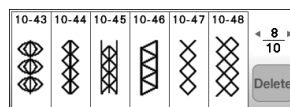
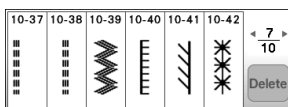
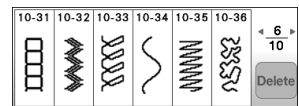
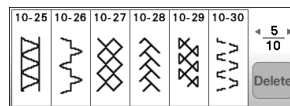
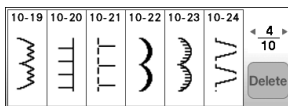
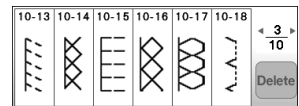
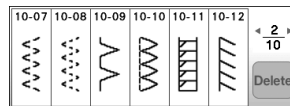
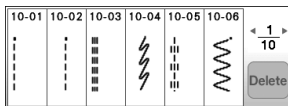

◆ Character Stitches

◆ Puntadas de carácter

◆ Points de caractères

A.B.あ ▶ AB

ABC abc	0-9 &?! aaa	AAA aaa	→W ↶↷			
A	B	C	D	E	F	← 1 5 →
G	H	I	J	K	L	Delete

ABC abc	0-9 &?! aaa	AAA aaa	→W ↶↷			
M	N	O	P	Q	R	← 2 5 →
S	T	U	V	W	X	Delete

ABC abc	0-9 &?! aaa	AAA aaa	→W ↶↷			
Y	Z	α	b	c	d	← 3 5 →
e	f	g	h	i	j	Delete

ABC abc	0-9 &?! aaa	AAA aaa	→W ↶↷			
k	l	m	n	o	p	← 4 5 →
q	r	s	t	u	v	Delete

ABC abc	0-9 &?! aaa	AAA aaa	→W ↶↷		
w	x	y	z	_	← 5 5 →
Delete					

ABC abc	0-9 &?! aaa	AAA aaa	→W ↶↷			
0	1	2	3	4	5	← 1 5 →
6	7	8	9	#	%	Delete

ABC abc	0-9 &?! aaa	AAA aaa	→W ↶↷			
\$	£	€	¥	-	+	← 2 5 →
X	÷	=	*	.	,	Delete

ABC abc	0-9 &?! aaa	AAA aaa	→W ↶↷			
&	?	!	@	<	>	← 3 5 →
(	)	[	]	/	\	Delete

ABC abc	0-9 &?! aaa	AAA aaa	→W ↶↷			
~	:	;	©	®	™	← 4 5 →
“	”	”	'	'	'	Delete

ABC abc	0-9 &?! aaa	AAA aaa	→W ↶↷			
_						← 5 5 →
Delete						

ABC abc	0-9 &?! aaa	AAA aaa	→W ↶↷			
Â	Ä	Å	Æ	à	á	← 1 5 →
â	ã	ä	å	æ	ç	Delete

ABC abc	0-9 &?! aaa	AAA aaa	→W ↶↷			
ç	Ð	È	É	Ê	Ë	← 2 5 →
è	é	ê	ë	Í	Ï	Delete

ABC abc	0-9 &?! aaa	AAA aaa	→W ↶↷			
İ	ı	ı	ï	İ	Ñ	← 3 5 →
Ñ	ñ	Ô	Ö	Ø	Õ	Delete

ABC abc	0-9 &?! aaa	AAA aaa	→W ↶↷			
œ	ø	ó	ô	ö	ø	← 4 5 →
ø	æ	r	t	Û	Ü	Delete

ABC abc	0-9 &?! aaa	AAA aaa	→W ↶↷			
ù	ú	û	ü	z	p	← 5 5 →
p	B	_	Delete			

A.B.あ ▶ AB

ABC abc	0-9 &?! aaa	AAA aaa	→W ↶↷			
A	B	C	D	E	F	← 1 5 →
G	H	I	J	K	L	Delete

ABC abc	0-9 &?! aaa	AAA aaa	→W ↶↷			
M	N	O	P	Q	R	← 2 5 →
S	T	U	V	W	X	Delete

ABC abc	0-9 &?! aaa	AAA aaa	→W ↶↷			
Y	Z	α	b	c	d	← 3 5 →
e	f	g	h	i	j	Delete

ABC abc	0-9 &?! aaa	AAA aaa	→W ↶↷			
k	l	m	n	o	p	← 4 5 →
q	r	s	t	u	v	Delete

ABC abc	0-9 &?! aaa	AAA aaa	→W ↶↷		
w	x	y	z	_	← 5 5 →
Delete					

ABC abc	0-9 &?! aaa	AAA aaa	→W ↶↷			
0	1	2	3	4	5	← 1 5 →
6	7	8	9	#	%	Delete

ABC abc	0-9 &?! aaa	AAA aaa	→W ↶↷			
\$	£	€	¥	-	+	← 2 5 →
X	÷	=	*	.	,	Delete

ABC abc	0-9 &?! aaa	AAA aaa	→W ↶↷			
&	?	!	@	<	>	← 3 5 →
(	)	[	]	/	\	Delete

ABC abc	0-9 &?! aaa	AAA aaa	→W ↶↷			
~	:	;	©	®	™	← 4 5 →
“	”	”	'	'	'	Delete

ABC abc	0-9 &?! aaa	AAA aaa	→W ↶↷			
_						← 5 5 →
Delete						

ABC abc	0-9 &?! aaa	AAA aaa	→W ↶↷			
À	Á	Â	Ã	ä	á	← 1 5 →
à	ã	ä	å	æ	ç	Delete

ABC abc	0-9 &?! aaa	AAA aaa	→W ↶↷			
ç	Ð	È	É	Ê	Ë	← 2 5 →
è	é	ê	ë	Í	Ï	Delete

ABC abc	0-9 &?! aaa	AAA aaa	→W ↶↷			
İ	ı	ı	ï	İ	Ñ	← 3 5 →
Ñ	ñ	Ô	Ö	Ø	Õ	Delete

ABC abc	0-9 &?! aaa	AAA aaa	→W ↶↷			
œ	ø	ó	ô	ö	ø	← 4 5 →
ø	æ	r	t	Û	Ü	Delete

ABC abc	0-9 &?! aaa	AAA aaa	→W ↶↷			
ù	ú	û	ü	z	p	← 5 5 →
p	B	_	Delete			

A.3.3 AB

ABC abc	0-9 &?! aaa	AAA aaa	→W ↔			
A	B	C	D	E	F	← 1/5 →
G	H	I	J	K	L	Delete

ABC abc	0-9 &?! aaa	AAA aaa	→W ↔			
M	N	O	P	Q	R	← 2/5 →
S	T	U	V	W	X	Delete

ABC abc	0-9 &?! aaa	AAA aaa	→W ↔			
Y	Z	a	b	c	d	← 3/5 →
e	f	g	h	i	j	Delete

ABC abc	0-9 &?! aaa	AAA aaa	→W ↔			
k	l	m	n	o	p	← 4/5 →
q	r	s	t	u	v	Delete

ABC abc	0-9 &?! aaa	AAA aaa	→W ↔		
w	x	y	z	_	← 5/5 →
Delete					

ABC abc	0-9 &?! aaa	AAA aaa	→W ↔			
0	1	2	3	4	5	← 1/5 →
6	7	8	9	#	%	Delete

ABC abc	0-9 &?! aaa	AAA aaa	→W ↔			
§	€	©	¥	□	+	← 2/5 →
×	÷	≡	✳	°	ρ	Delete

ABC abc	0-9 &?! aaa	AAA aaa	→W ↔			
&	?	!	@	<	>	← 3/5 →
(	)	[	]	/	\	Delete

ABC abc	0-9 &?! aaa	AAA aaa	→W ↔			
~	°	°	°	™	™	← 4/5 →
σ	ρ	σ	ρ	σ	ρ	Delete

ABC abc	0-9 &?! aaa	AAA aaa	→W ↔			
_						← 5/5 →
Delete						

ABC abc	0-9 &?! aaa	AAA aaa	→W ↔			
Â	Ä	Å	Æ	à	á	← 1/5 →
â	ä	å	æ	ç	Ç	Delete

ABC abc	0-9 &?! aaa	AAA aaa	→W ↔			
Ç	Ð	È	É	Ê	Ë	← 2/5 →
è	é	ê	ë	í	ï	Delete

ABC abc	0-9 &?! aaa	AAA aaa	→W ↔			
İ	ı	ı	ı	ı	Ñ	← 3/5 →
ñ	ñ	ö	ö	ø	ö	Delete

ABC abc	0-9 &?! aaa	AAA aaa	→W ↔			
œ	ò	ó	ô	ö	ø	← 4/5 →
ó	œ	ř	ť	Ů	ů	Delete

ABC abc	0-9 &?! aaa	AAA aaa	→W ↔			
ù	ú	û	ü	z	P	← 5/5 →
þ	ß	_				Delete

A.3.4 AB

АБВ абв	0-9 &?! aaa	AAA aaa	→W ↔			
А	Б	В	Г	Д	Е	← 1/4 →
Ё	Ж	З	И	Й	К	Delete

АБВ абв	0-9 &?! aaa	AAA aaa	→W ↔			
Л	М	Н	О	П	Р	← 2/4 →
С	Т	У	Ф	Х	Ц	Delete

АБВ абв	0-9 &?! aaa	AAA aaa	→W ↔			
Ч	Ш	Щ	Ъ	Ы	Ь	← 3/4 →
Э	Ю	Я	Г	Е	І	Delete

АБВ абв	0-9 &?! aaa	AAA aaa	→W ↔			
İ	ı	ı	ı	ı	ı	← 4/4 →
Һ	Ц	Ғ	Ѕ	Ҝ	_	Delete

АБВ абв	0-9 &?! aaa	AAA aaa	→W ↔			
а	б	в	г	д	е	← 1/4 →
ё	ж	з	и	й	к	Delete

АБВ абв	0-9 &?! aaa	AAA aaa	→W ↔			
Л	М	Н	О	П	Р	← 2/4 →
С	Т	У	Ф	Х	Ц	Delete

АБВ абв	0-9 &?! aaa	AAA aaa	→W ↔			
ч	ш	щ	ъ	ы	ь	← 3/4 →
э	ю	я	г	е	і	Delete

АБВ абв	0-9 &?! aaa	AAA aaa	→W ↔			
ı	ı	ı	ı	ı	ı	← 4/4 →
Һ	Ц	Ғ	Ѕ	Ҝ	_	Delete

АБВ абв	0-9 &?! aaa	AAA aaa	→W ↔			
0	1	2	3	4	5	← 1/2 →
6	7	8	9	-	.	Delete

АБВ абв	0-9 &?! aaa	AAA aaa	→W ↔			
,	&	?	!	(	)	← 2/2 →
/	'	_	Delete			

Katakana characters: One of the Japanese character sets  
 Caracteres Katakana: Uno de los diferentes conjuntos de caracteres japoneses.  
 Caractères Katakana : Un des ensembles de caractères japonais.

Arabic numerals, Japanese Kanji numerals  
 Números arábigos, números Kanji japoneses  
 Chiffres arabes, chiffres Kanji japonais

Kanji characters: Often used in daily life / symbols.  
 Caracteres Kanji: se utilizan a menudo cotidianamente / como símbolos.  
 Caractères Kanji : souvent utilisés dans la vie de tous les jours/symboles.

Hiragana characters: One of the Japanese character sets  
 Caracteres Hiragana: Uno de los diferentes conjuntos de caracteres japoneses.  
 Caractères Hiragana : Un des ensembles de caractères japonais.



Horizontal  
 Horizontal  
 Horizontal  
 Vertical  
 Vertical  
 Vertical



<p><b>あ行</b></p>	<p><b>か行</b></p>	<p><b>さ行</b></p>
<p><b>た行</b></p>	<p><b>な行</b></p>	
<p><b>は行</b></p>	<p><b>ま行</b></p>	
<p><b>や行</b></p>	<p><b>ら行</b></p>	<p><b>わ行</b></p>



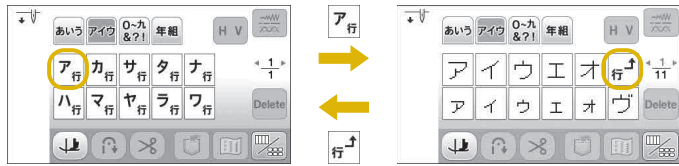

ア行



カ行



サ行



タ行



ナ行



ハ行



マ行



ワ行



ヤ行



ラ行



フ行



- Example of Kanji characters in daily life
- Ejemplo de caracteres Kanji en la vida cotidiana
- Exemple de caractères Kanji dans la vie quotidienne

一 二 三 四 五 六 七 八 九 十

1, 2, 3, 4, 5, 6, 7, 8, 9, 10

生 年 月 日

Date of birth

Fecha de nacimiento

Date de naissance

一 才

1 year old

1 año de edad

1 an

保 育 園

Nursery school

Guardería

Crèche

幼 稚 園

Kindergarten

Jardín de infancia

École maternelle

小 学 校

Elementary school

Escuela primaria

École primaire

中 学 校

Junior high school

Escuela secundaria

Collège

組

Group/Class

Grupo/Clase

Groupe/Classe

部

Club/Division

Club/División

Club/Division

月

Moon/Monday

Luna/Lunes

Lune/Lundi

火

Fire/Tuesday

Fuego/Martes

Feu/Mardi

水

Water/Wednesday

Agua/Miércoles

Eau/Mercredi

木

Tree/Thursday

Árbol/Jueves

Arbre/Jeudi





Gold/Friday

Oro/Viernes

Or/Vendredi



Soil/Saturday

Tierra/Sábado

Terre/Samedi



Sun/Sunday

Sol/Domingo

Soleil/Dimanche

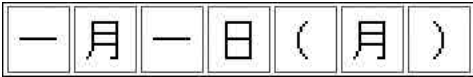

January 1st (Monday)

1 de enero (lunes)

1er janvier (lundi)



# Preparing to Embroider

## Preparativos para bordar

## Préparation de la broderie

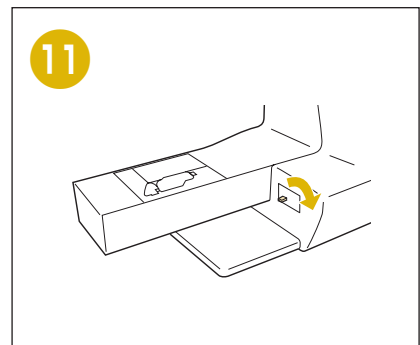
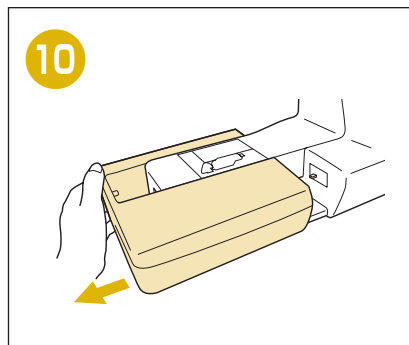
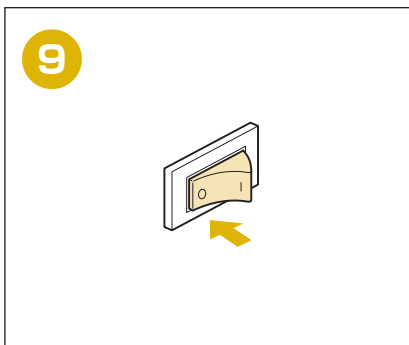
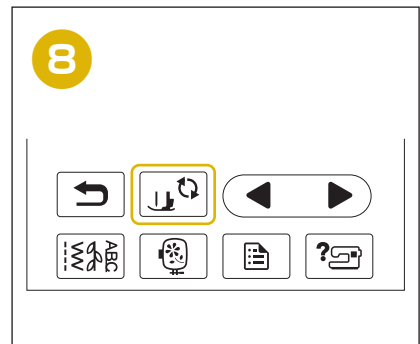
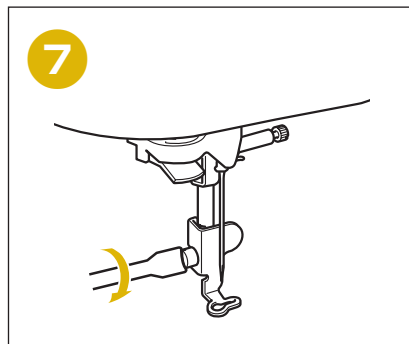
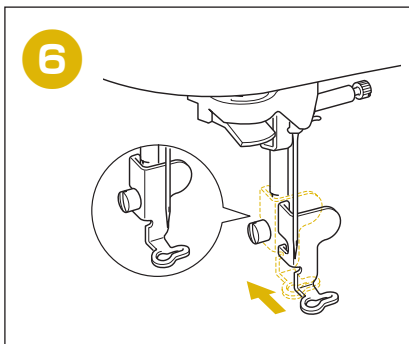
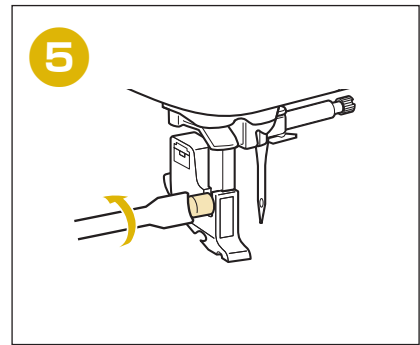
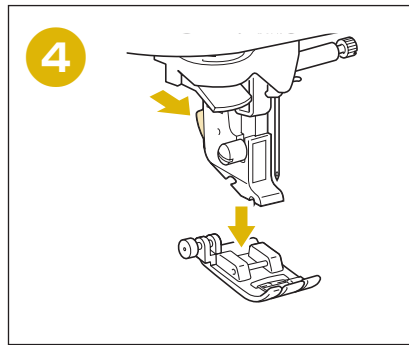
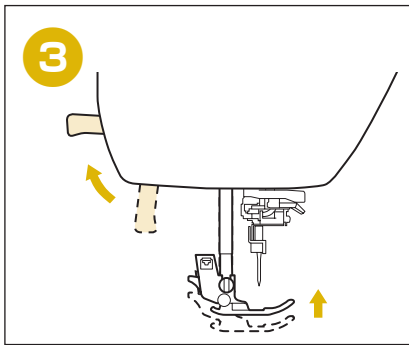
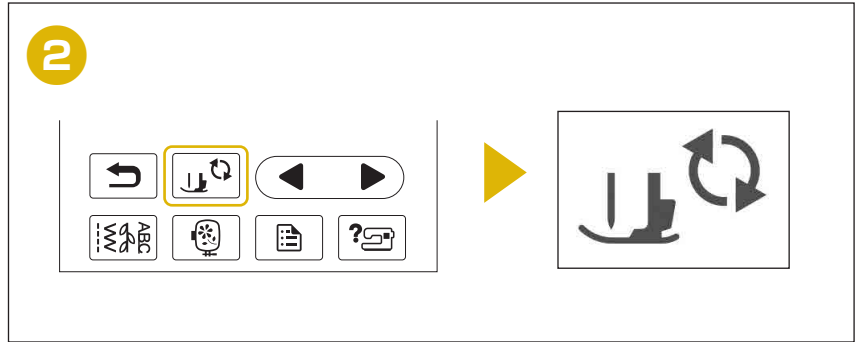
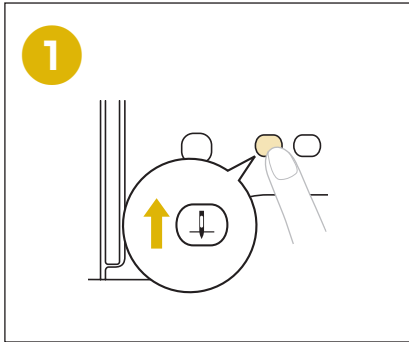

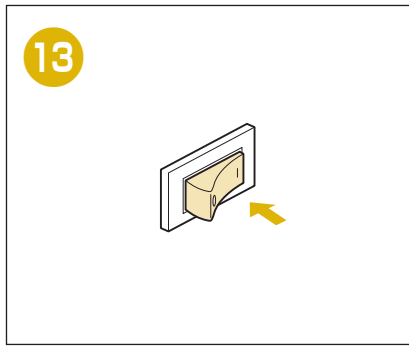
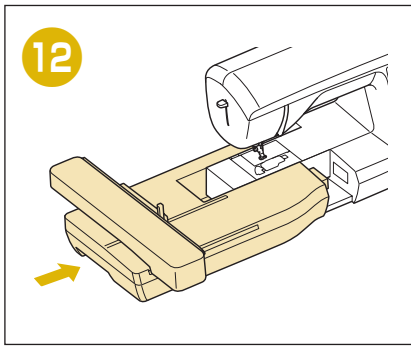

14

  
The carriage of the embroidery unit will move. Keep your hands etc. away from the carriage.

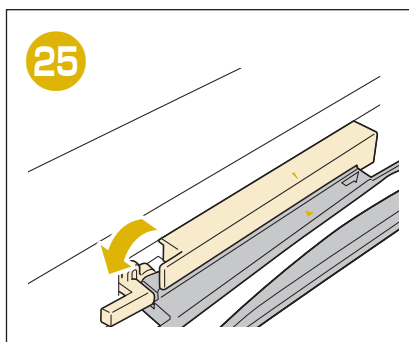
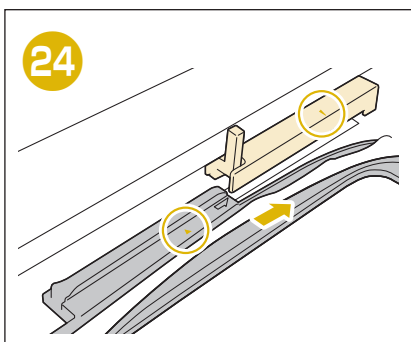
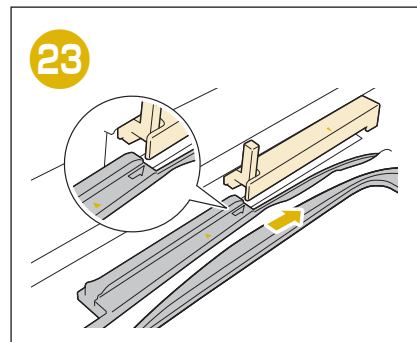
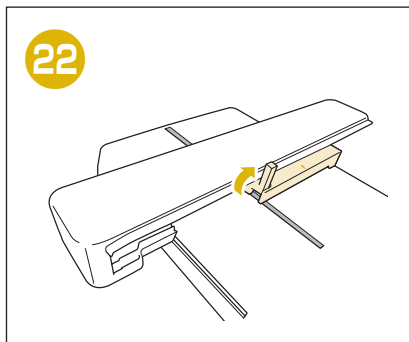
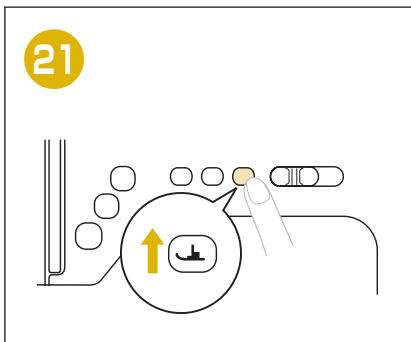
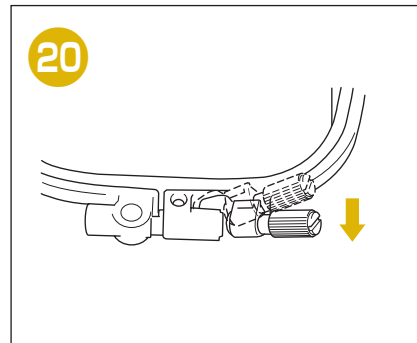
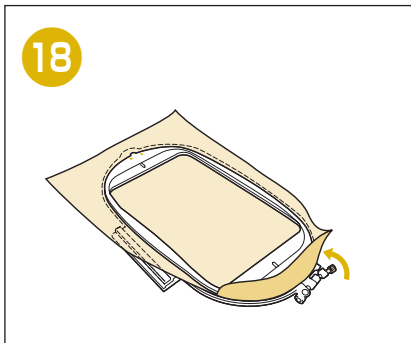
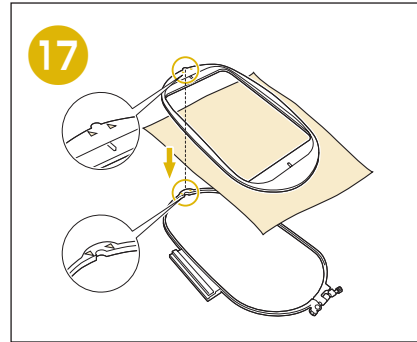
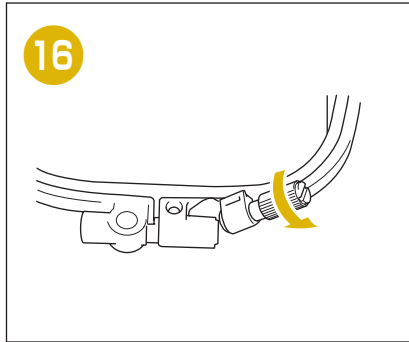
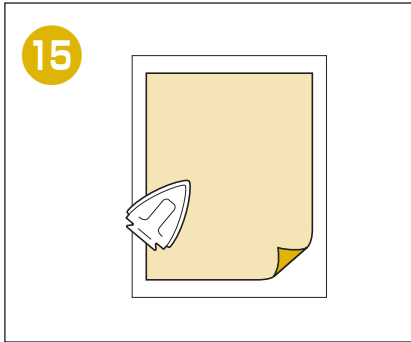



# Selecting Embroidery Patterns

## Seleccionar patrones de bordado

### Sélection des motifs de broderie

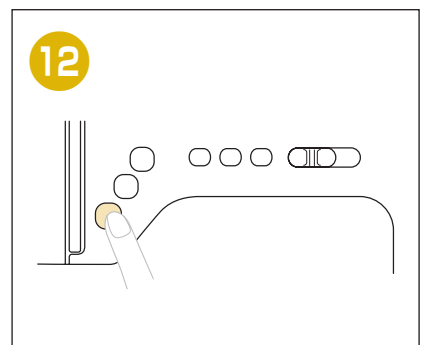
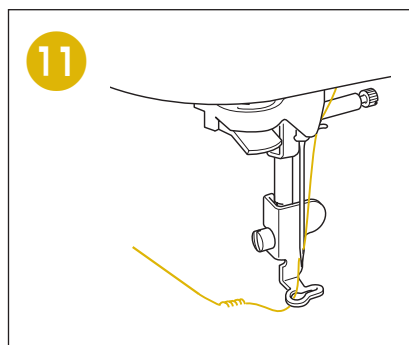
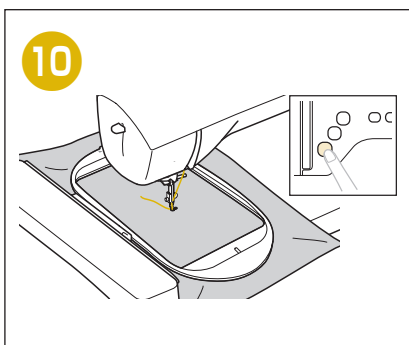
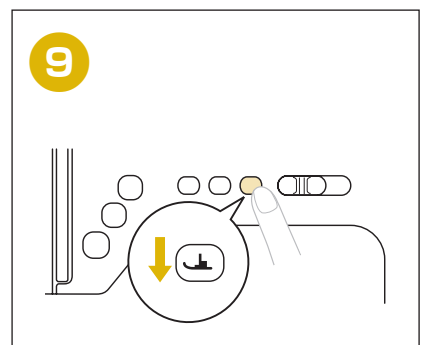
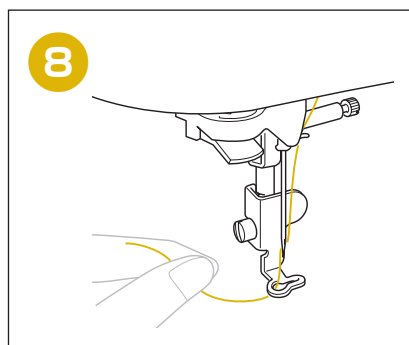
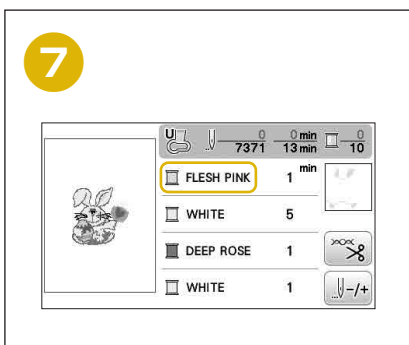
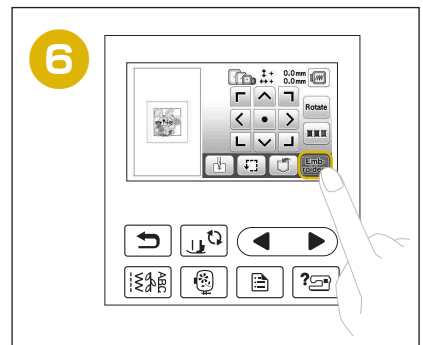
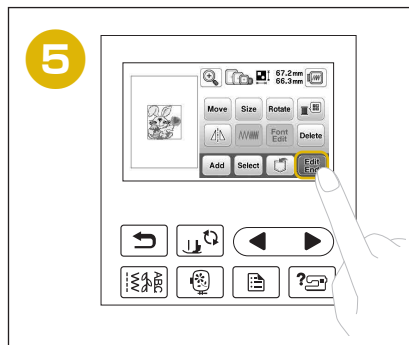
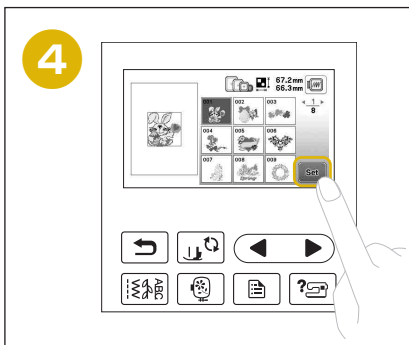
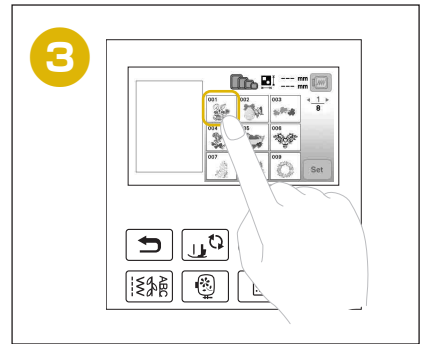
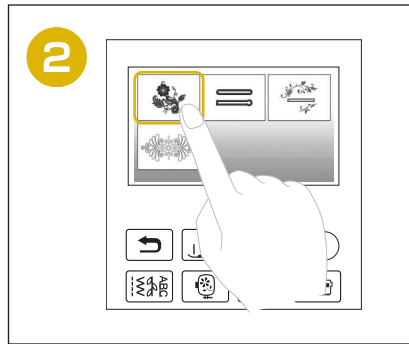
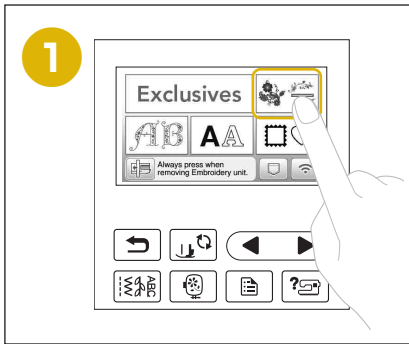

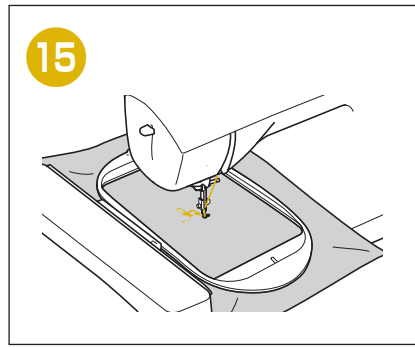
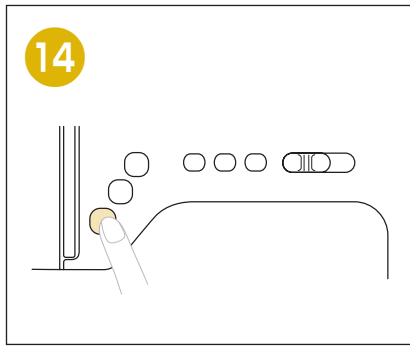
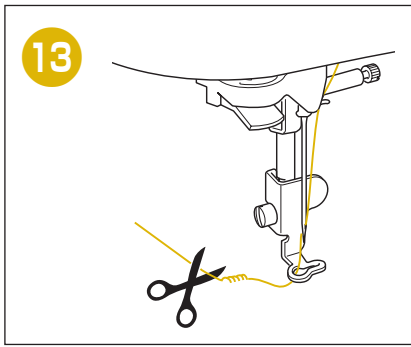





English  
Spanish  
French  
888-G31



D01W2S-001